

Swirl 10

Square From Silver Rectangle

★
Use ten silver rectangles
A7 or larger
Finished model ratio 2.5

The units only have folds from the procedure to make a square from rectangle. A single fold is added to each unit during assembly. It is surprising at first that the two sides are so different. However, both sides only have rotational symmetry.

Module ★

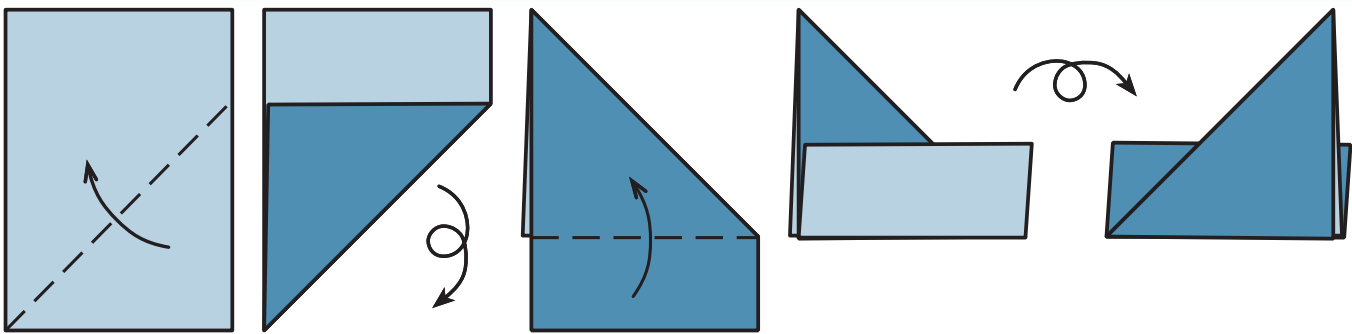

1 Bisect the lower left right angle. Turn over.

2 Fold the lower flap up so that the fold aligns with the raw edge behind it.

3 Turn over.

Assembly ★

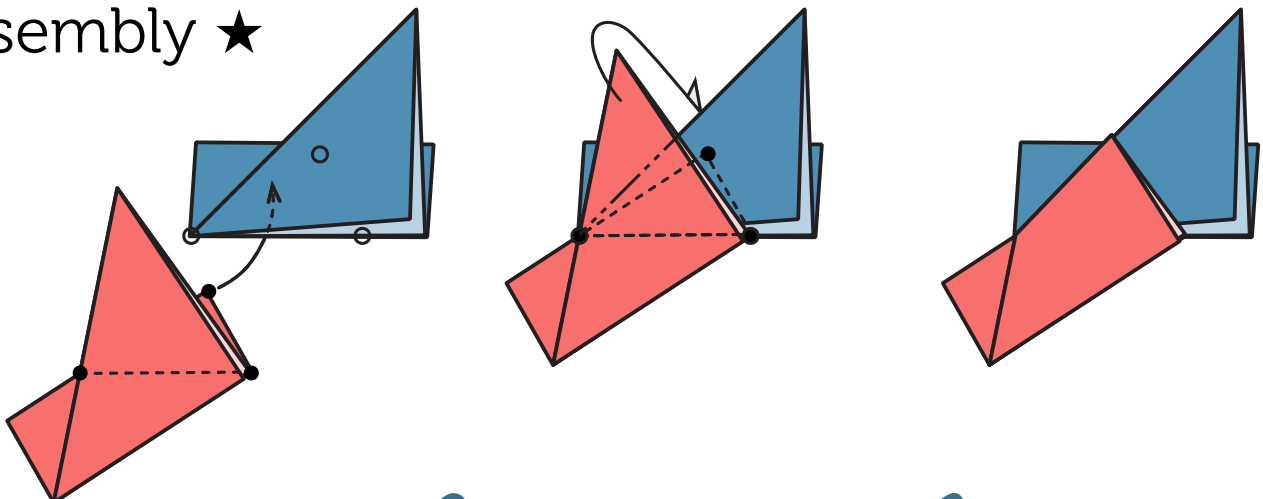

1 Tuck the corner of the rear flap of the second unit into first unit, between the two layers of its square. The diagonal of the silver rectangle of the leftover rectangle aligns with the edge of the first unit.

2 Mountain fold the flap of the second unit behind to lock.

3 Continue adding units in a clockwise direction.