

Star 3

Square From Silver Rectangle

★
Use three silver rectangles
A8 or larger and
one for the template
Finished model ratio 2.0

Using a template for the 60° folds avoids extraneous creases and can be more accurate. The model relies on $\sqrt{2}+1$ being slightly greater than $4\sqrt{3}\div 3$, i.e. $2.414 > 2.309$. Shorter rectangles would make a bigger central hole.

Template ★

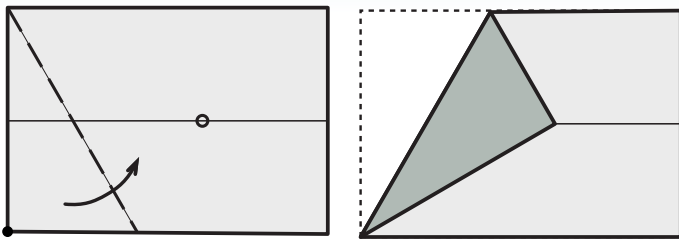

Module ★

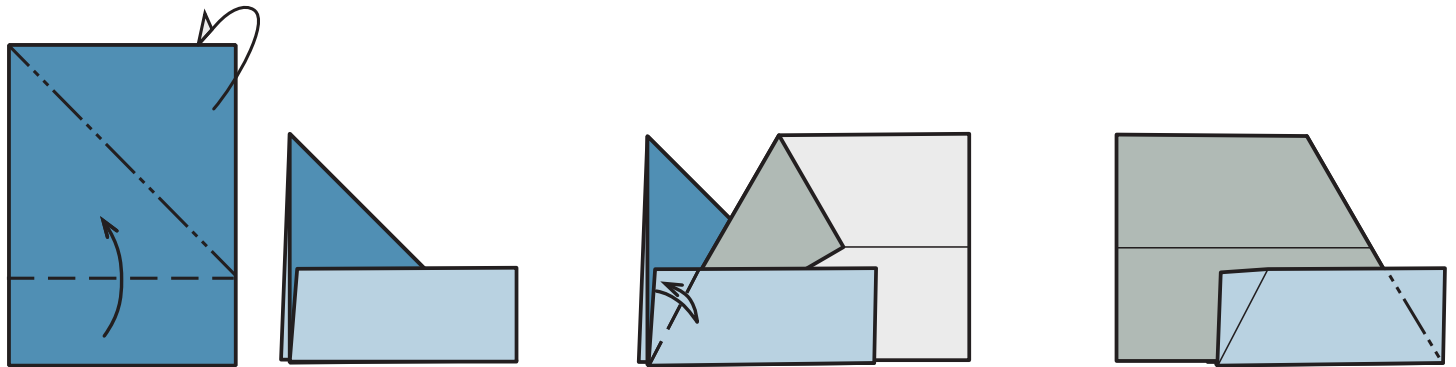

1 Perform the square from rectangle procedure.

2 Insert the template and valley fold the left corner.

3 Remove the template and insert. Mountain fold the right corner.

Assembly ★

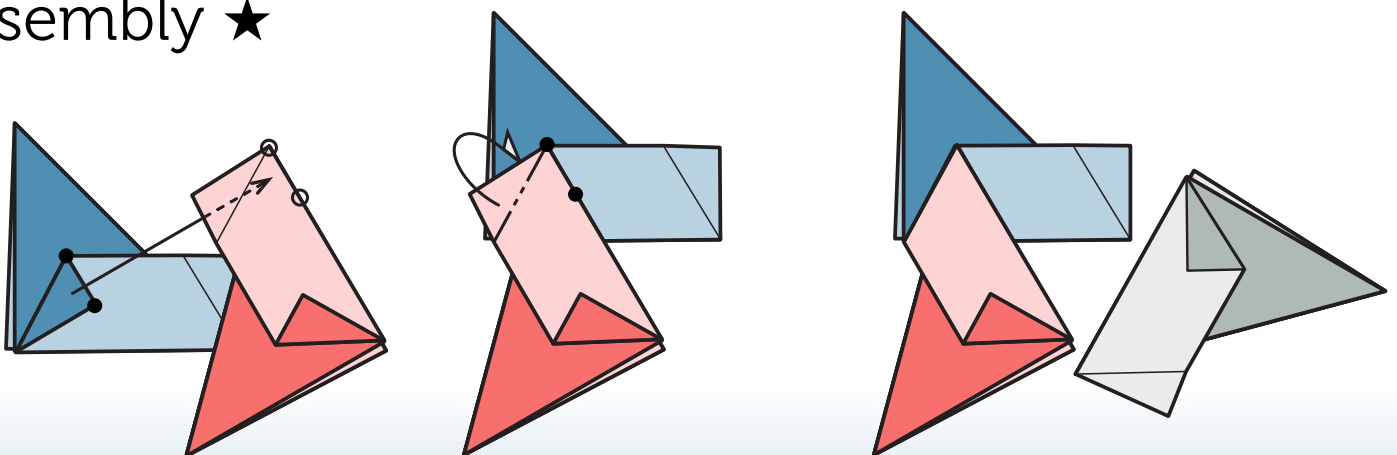

1 Hook the first unit into the second unit.

2 Mountain fold behind to lock.

3 Add the third unit to the second unit. Join it to the first.